

Under the web-address <https://www.process-informatik.de> are product specific documentations or software-driver/-tools available to download.  
If you have questions or suggestions about the product, please don't hesitate to contact us.

Process-Informatik Entwicklungsgesellschaft mbH

Im Gewerbegebiet 1

DE-73116 Wäschenbeuren

+49 (0) 7172-92666-0

[info@process-informatik.de](mailto:info@process-informatik.de)

<https://www.process-informatik.de>

**Menutree Website:**

- + Products / docu / downloads
- + Accessories
  - + Connection cable / adapter
  - + USB
    - + USB 2.0 connection cable type A/Mini B



**QR-Code Website:**



Please make sure to update your drivers before using our products.

## Recognize missing Profinet participants

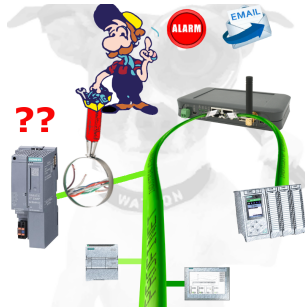

Recognize cable breakage, contact problems and line faults.  
Retransmissions and failures are logged and reported.  
Early acting before total failure of the participant.

## Data backup S5-PLC on SD-card

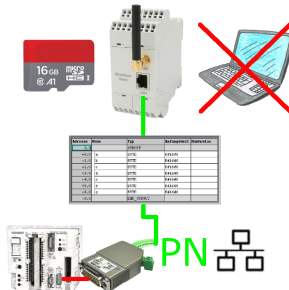

S5-PLC triggered DB-backup/-restore without additional PC via PG-socket and Ethernet on SD-card

## WinTELEPROF-software = software-PG-TELE

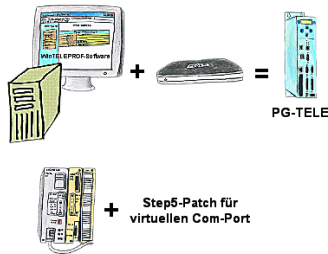

You're using the devices of the Tele-Network-family and don't want to have a device standing on the table? No problem. Install the WinTELEPROF-software on your PC and after link connection access to your Step5/7-programming software (also Siemens) via a virtual Com-Port.

At Step5 the Step5-software is going to be patched, then working with the virtual Com-Port will be also possible.

## Worldwide remote-access thanks to our own cloud

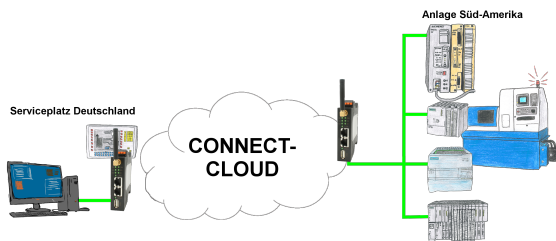

Worldwide remote-maintenance without additional costs thanks to our own cloud

Your devices connect to your own cloud, no matter where they are in the world. Only your devices are in your own private cloud, no one else has access to the cloud. In addition, you can provide each device with its own connection-password, so that the individual systems are protected despite the private cloud.

No registration on any portals, no hidden additional costs, your devices in your own cloud are always accessible.

This is how remote maintenance/remote access is fun.

## Protection against virus attacks

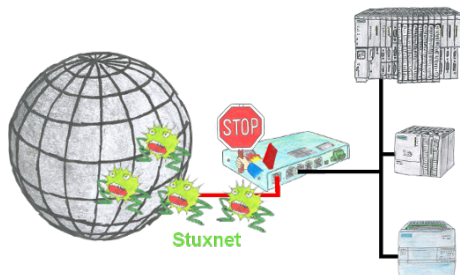

Protection of your systems against virus-attacks such as "Stuxnet"

Switch the S7-Firewall or TeleRouter with the S7-firewall-option between the PLC(s)/machine-network and the company-network to prevent your system- and process-data from being destroyed.

## Remote maintenance of centralized PLC-devices

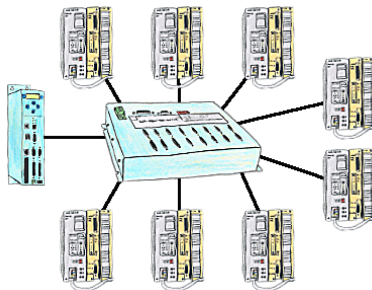

You have many PLC and you want to programm them central on one place? No problem, you have to connect them all to the KOR/MUX-Tele-Switch, connect it with the TP-II and after telephone connect you will be able with the PD-bus-selection of your Step5-software to go ONLINE. Of course the MOR/MUX-Tele-Switch is cascadable, so you can connect up to 30 PLCs to the devices.