

# Mounting-instruction ALF-wall-antenna

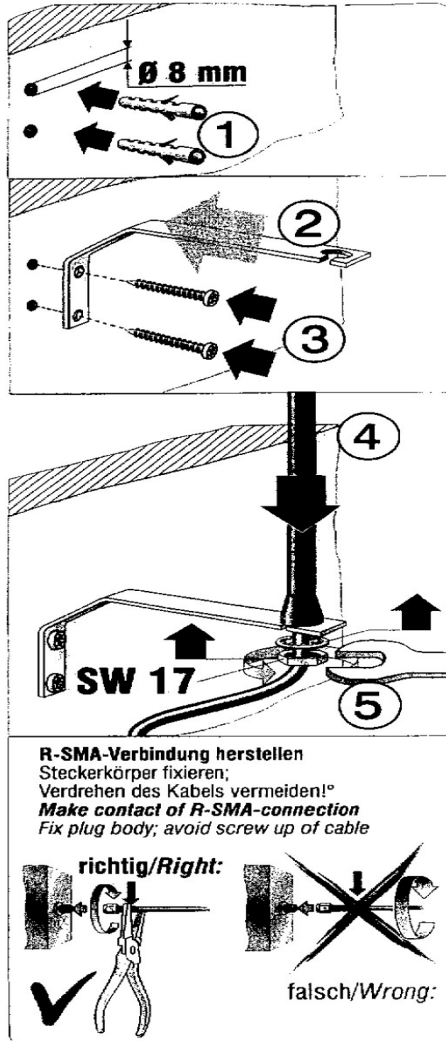

Under the web-address <https://www.process-informatik.de> are product specific documentations or software-driver/-tools available to download.  
If you have questions or suggestions about the product, please don't hesitate to contact us.

Process-Informatik Entwicklungsgesellschaft mbH

Im Gewerbegebiet 1

DE-73116 Wäschenbeuren

+49 (0) 7172-92666-0

[info@process-informatik.de](mailto:info@process-informatik.de)

<https://www.process-informatik.de>

Copyright by PI - 2025

**Menutree Website:**

+ Products / docu / downloads

+ Antenna for S5-/S7-BRIDGE / CONNECT

**QR-Code Website:**



Please make sure to update your drivers before using our products.

## To switch a MESSI-output via SMS



SMS-Versenden.  
PASS=12345 DO1=1,15

```
PASS=12345 DO1=1,15
| | | | | 15 Sekunden Schaltzeit (0 bedeutet dauernd an)
| | | | | 1 - EIN, 2 - AUS (bei AUS wird keine Schaltzeit beachtet)
| | | | | DO1 Schaltelement für Digitalausgang (DO1 bis DO8 möglich)
| | | | | Passwort aus dem Menüpunkt Geräteeingang
| | | | | Schaltelement für Passwort
```

Switching an output via SMS is an integrated function of the MESSI. Herewith the switching operation will be secure and comprehensible from afar.

## Longer distances for L1-Bus

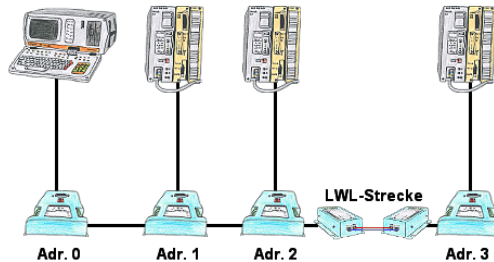

You need for your L1-Bus higher distance like the possible 1200m? You have strong disturbance on your L1-Bus? You need a serial line for higher distances and this galvanic decoupled? No problem, all this points are solved through the LWL-adapter. They are available for artificial and optical fibre, for L1-Bus and RS232.



You need a web-visualization which is kept simple, with no additional Plugins like ActiveX, Flash(R) or Java(R) and is compatible with most general browser? Then you have found with S7-Visu the solution. Visualizations under Windows(R)/Linux on PC-based systems are just realizable as those for tablets or Phones with browser support. The simultaneous operation of multiple browsers at the same time is possible.

### Use on-site without PC-adapter?



With the TeleService-device you can connect serial or by USB-cable to your PC/laptop and then communicate directly with the control without a PC-adapter or other S7-programming cables.

The USB-cable is a standard-cable just as the one you use at your printer.